

# M250 SERIES

Our M250 has the shortest OAL of our 38.0mm (1.496") diameter cylinders. This feature makes the M250 both compact and versatile.

To adjust pressure on the M250 cylinder, please use a CAM6R Charging Adapter and a DTM6R Discharge Tool.

We recommend that all cylinders be backed-up during operation.

The M250 may be hosed into a system using our Micro-Line miniature hose assemblies and fittings.

## M250 TAPPED BASE STYLE

Specify "TB" when ordering

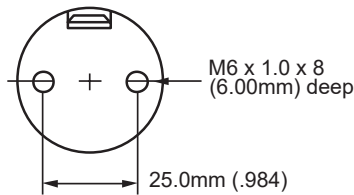
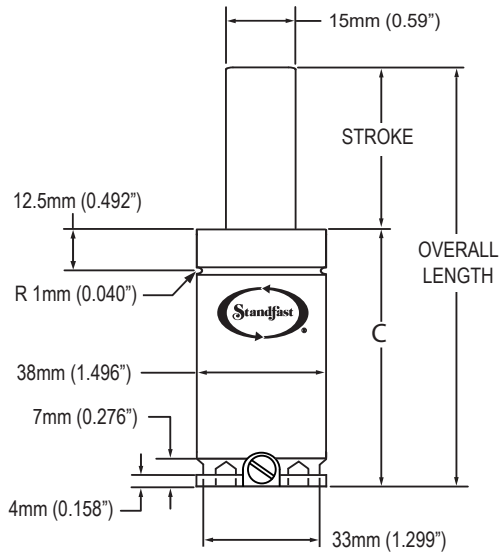

## M250 STUD MOUNT STYLE

Specify "STUD" when ordering

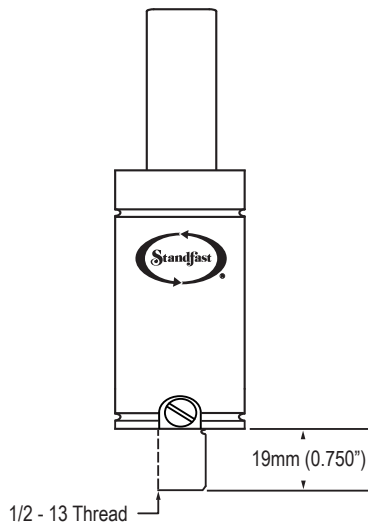

## M250 STROKE CHART

STROKE LENGTH		MAX.ALLOW. STROKE		C		OVERALL LENGTH		WEIGHT
MM	INCHES	MM	INCHES	MM +/- .5	INS +/- .02	MM +/- .5	INS +/- .02	IN LBS.
* 13.0	0.492	10.0	0.394	42.5	1.673	55.0	2.165	0.66
15.0	0.590	12.0	0.472	45.0	1.772	60.0	2.362	0.68
19.0	0.748	16.0	0.630	49.0	1.929	68.0	2.677	0.73
25.0	0.984	22.0	0.866	55.0	2.165	80.0	3.150	0.80
* 32.0	1.300	29.0	1.142	63.0	2.480	96.0	3.780	0.88
* 38.0	1.476	35.0	1.380	67.5	2.657	105.0	4.134	0.96
50.0	1.968	47.0	1.850	80.0	3.150	130.0	5.118	1.10
* 63.0	2.461	60.0	2.362	92.5	3.642	155.0	6.102	1.26
75.0	2.953	72.0	2.835	105.0	4.134	180.0	7.087	1.40
80.0	3.150	77.0	3.031	110.0	4.331	190.0	7.480	1.46
* 100.0	3.957	97.0	3.819	130.5	5.138	231.0	9.094	1.70
125.0	4.921	122.0	4.803	155.0	6.102	280.0	11.023	2.00

Recommended tolerance on machined pocket in the die is 40.0/42.0 (1.575/1.653) for maximum M250 performance.

\* Please note: Millimeter value for these stroke lengths is rounded. Inch value indicates actual stroke length.

D-1

## M250 FORCE CHART based on 2,000 psi/138 Bar

Initial contact force for the M250 is 546 lbs.

STROKE		TRAVEL											
MM	INCHES	13.0	15.0	19.0	25.0	32.0	38.0	50.0	63.0	75.0	80.0	100.0	125.0
13.0	0.51	729											
15.0	0.59	700	731										
19.0	0.75	663	686	736									
25.0	0.98	632	648	682	739								
32.0	1.26	612	623	648	688	742							
38.0	1.50	601	610	630	662	704	744						
50.0	1.97	587	594	608	631	659	686	746					
63.0	2.48	578	583	594	611	633	652	694	747				
75.0	2.95	573	577	586	600	617	633	666	706	748			
80.0	3.15	571	575	584	596	612	627	657	694	732	748		
100.0	3.94	566	569	576	586	598	609	632	659	686	697	749	
125.0	4.92	562	564	570	577	587	595	613	633	653	661	698	750

Formula to calculate charge pressure for lower initial contact pressure is: FORCE REQUIRED x 3.663 (ex. 325 x 3.663 = 1190 psi charge in cylinder).

PLEASE NOTE: A max. charge pressure of 2175 PSI/150 Bar is available upon request. Initial contact force at 2175 PSI/150 Bar will be 596 lbs (265 daN).

ORDERING CODE: M250 X STROKE LENGTH—MOUNT STYLE—CHARGE PRESSURE